

CURVE SCHEDULE				
CURVE	RADIUS	ARC	CHORD	CHORD BEARING
C1	15.00	40.00	29.16	N32°47'10"W
C2	15.00	11.95	11.63	N86°20'40"W
C3	15.00	6.60	6.55	N76°08'00"W
C4	15.00	5.35	5.32	N81°02'50"E
C5	15.00	15.12	14.49	N80°17'00"W
C6	15.00	11.50	11.22	N29°26'10"W
C7	15.00	13.37	12.93	N18°03'30"E
C8	15.00	10.46	10.25	N23°37'30"E
C9	15.00	4.78	4.76	N34°28'10"E
C10	15.00	5.68	5.64	N14°28'50"E
C11	15.00	43.07	29.73	N47°30'20"E
C12	15.00	10.05	9.87	N15°32'40"W
C13	15.00	8.02	7.93	N19°25'30"W
C14	15.00	13.46	13.01	N21°35'40"E
C15	15.00	14.67	14.09	N75°18'10"E
C16	15.00	6.92	6.86	N65°28'10"W
C17	15.00	8.53	8.42	N86°32'30"W
C18	15.00	41.00	29.38	N42°52'10"W
C19	15.00	9.12	8.98	N76°08'10"E
C20	15.00	3.41	3.41	N87°08'10"E
C21	15.00	5.71	5.67	N69°43'00"E
C22	15.00	9.39	9.24	N76°45'10"E
C23	15.00	12.70	12.33	N61°03'00"W
C24	15.00	13.13	12.71	N11°42'50"W
C25	15.00	5.78	5.75	N24°24'00"E
C26	15.00	8.32	8.22	N19°32'50"E

SCHEDULE "A"

INTEGRATION DATA		
COORDINATES ARE DERIVED FROM GPS OBSERVATIONS USING THE CAN-NET NETWORK SERVICE AND ARE REFERRED TO UTM ZONE 17 (81° WEST LONGITUDE) NAD83 (CSRS) (1997.0).		
COORDINATE VALUES ARE TO AN URBAN ACCURACY IN ACCORDANCE WITH SECTION 14(2) O.R.G. 216/10		
POINT ID	NORTHING	EASTING
ORP-A	N4685473.031	E351359.370
ORP-B	N4685118.654	E351336.736
COORDINATES CANNOT, IN THEMSELVES, BE USED TO RE-ESTABLISH CORNERS OR BOUNDARIES SHOWN ON THIS PLAN.		

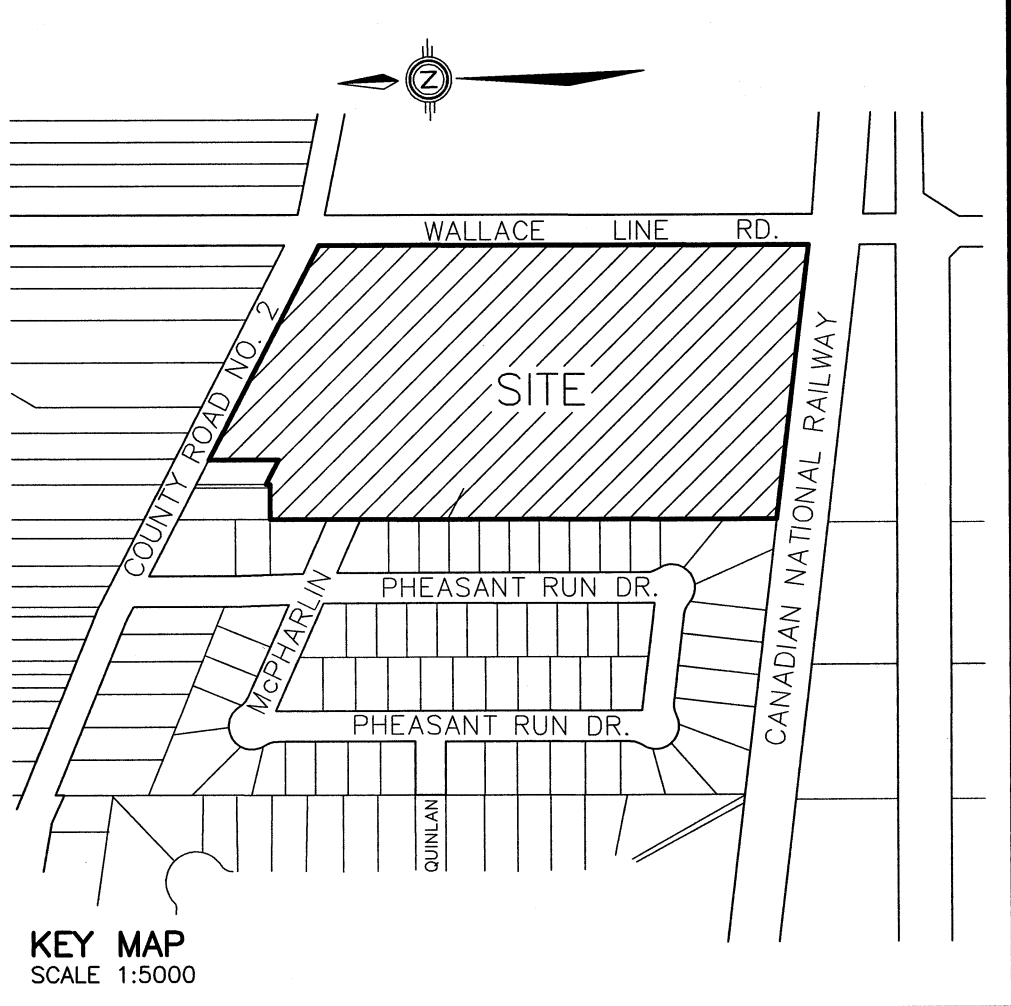

DRAFT PLAN OF SUBDIVISION
 OF
PART OF LOT 1,
LAKEHORE RANGE BETWEEN
PIKE CREEK AND PUCE RIVER
 GEOGRAPHIC TOWNSHIP OF MILDSTONE
 NOW IN THE
TOWN OF LAKEHORE
COUNTY OF ESSEX, ONTARIO
 © VERHAEGEN • STUBBERFIELD • HARTLEY • BREWER • BEZAIRE INC.
 SCALE = 1:500

LEGEND AND NOTES
 BEARINGS ARE UTM GRID DERIVED FROM OBSERVED REFERENCE POINTS "A" AND "B" BY REAL TIME NETWORK OBSERVATIONS.
 DISTANCES ON THIS PLAN ARE GROUND AND CAN BE CONVERTED TO GRID BY MULTIPLYING BY THE COMBINED SCALE FACTOR OF 0.99984803
 SIB DENOTES 25mm X 25mm X 1.22m STANDARD IRON BAR
 SSB DENOTES 25mm X 25mm X 0.61m SHORT STANDARD IRON BAR
 # DENOTES 16mm X 16mm X 0.61m IRON BAR
 # DENOTES 19mm diameter X 0.61m ROUND IRON BAR
 C DENOTES CUT-CROSS
 # DENOTES 5mm X 50mm STEEL PIN
 # DENOTES SURVEY MONUMENT FOUND
 # DENOTES SURVEY MONUMENT SET AND MARKED 1528
 # DENOTES WITNESS
 # DENOTES SET
 # DENOTES MEASURED
 # DENOTES DEED
 # DENOTES SET PROPORTIONALLY
 # DENOTES PLAN 12R-24261
 # DENOTES PLAN 12R-4081
 # DENOTES VERHAEGEN STUBBERFIELD HARTLEY BREWER BEZAIRE INC., O.L.S.
 # DENOTES RICHARD W. MURRAY, O.L.S.
 # DENOTES MINISTRY OF TRANSPORTATION, ONTARIO
 # DENOTES HOWARD B. HEAD, O.L.S.
 # DENOTES CLARKE SURVEYORS INC., O.L.S.
 # DENOTES JOHN B. SWEETON INC., O.L.S.
 # DENOTES MINISTRY OF GOVERNMENT SERVICE

ADDITIONAL INFORMATION
 REQUIRED UNDER SECTION 51(17) OF THE PLANNING ACT, (R.S.O. 1990)
 (A) AS SHOWN ON PLAN (F) AS SHOWN ON PLAN
 (B) AS SHOWN ON PLAN (G) AS SHOWN ON PLAN
 (C) AS SHOWN ON PLAN (H) PIPED MUNICIPAL
 (D) SINGLE FAMILY RESIDENTIAL (I) CLAY LOAM
 (E) NORTH - PUBLIC RIGHT OF WAY (J) AS SHOWN ON PLAN
 (F) EAST - PUBLIC RIGHT OF WAY (K) ALL SERVICES TO BE PROVIDED
 (G) SOUTH - RAILWAY (L) AS SHOWN ON PLAN
 (H) WEST - RESIDENTIAL

SUMMARY
 TOTAL NUMBER OF LOTS 57
 TOTAL NUMBER OF BLOCKS 4
 TOTAL AREA OF SITE 6.265 Hectares
 DENSITY 9.098 Lots per Hectares

OWNER'S CERTIFICATE
 I HEREBY AUTHORIZE THE FILING OF THIS DRAFT PLAN FOR APPROVAL.
 2204157 ONTARIO LTD.

DATE: _____ TERRY RAFIH
 "I HAVE THE AUTHORITY TO BIND THE CORPORATION"

SURVEYOR'S CERTIFICATE
 I CERTIFY THAT:
 THE BOUNDARIES OF THE LANDS TO BE SUBDIVIDED AND THEIR RELATIONSHIP TO THE ADJACENT LANDS HAVE BEEN ACCURATELY AND CORRECTLY SHOWN.

DATE: FEBRUARY 3, 2016
 ROY A. SIMONE
 for VERHAEGEN STUBBERFIELD HARTLEY BREWER BEZAIRE INC.
 WINDSOR 944 Ottawa Street N8X 2E1 Pk (519)228-1772 Fax (519)228-1751
 LEAMINGTON 187 Talbot Street East N8H 1L8 Pk (519)322-2375 Fax (519)322-2975
 ONTARIO LAND SURVEYORS www.vshbssurveys.com

SITE AREAS			
TOTAL AREA OF SITE		6.265 Hectares	
TOTAL AREA OF ROADS		1.162 Hectares	
BLOCK	CONVEYED TO	PURPOSE	AREA
BLOCK 60	TOWN OF LAKEHORE	ROADWAY	0.124 Ha.
BLOCKS 58 & 59	TOWN OF LAKEHORE	ROADWAY	0.061 Ha.
BLOCK 61	COUNTY OF ESSEX	PARKLAND	0.115 Ha.
ESSEX COUNTY ROAD 2	COUNTY OF ESSEX	ROADWAY	101.8 sq.m.

"METRIC" DISTANCES AND COORDINATES SHOWN ON THIS PLAN ARE IN METRES AND CAN BE CONVERTED TO FEET BY DIVIDING BY 0.3048

